

Shoppes on Main

Gaylord, Michigan

SHOPPES ON MAIN		
ADDRESS	TENANT	SQ. FT.
1366 WEST MAIN	ALDI FOOD MARKET:	18,850 SQ. FT.
1368 WEST MAIN	PANERA BREAD:	4,630 SQ. FT.
1372 WEST MAIN	FIVE GUYS:	2,401 SQ. FT.
1378 WEST MAIN	WILD BILLS:	1,600 SQ. FT.
1380 WEST MAIN	GREAT CLIPS:	1,400 SQ. FT.
1382 WEST MAIN	TROPIC SMOOTHIE:	1,600 SQ. FT.
1384 WEST MAIN	AVAILABLE 2:	2,873 SQ. FT.
1368 WEST MAIN	AVAILABLE 3:	3,356 SQ. FT.
SHOPPES ON MAIN:		36,710 SQ. FT.
OUTPARCEL AVAILABLE		

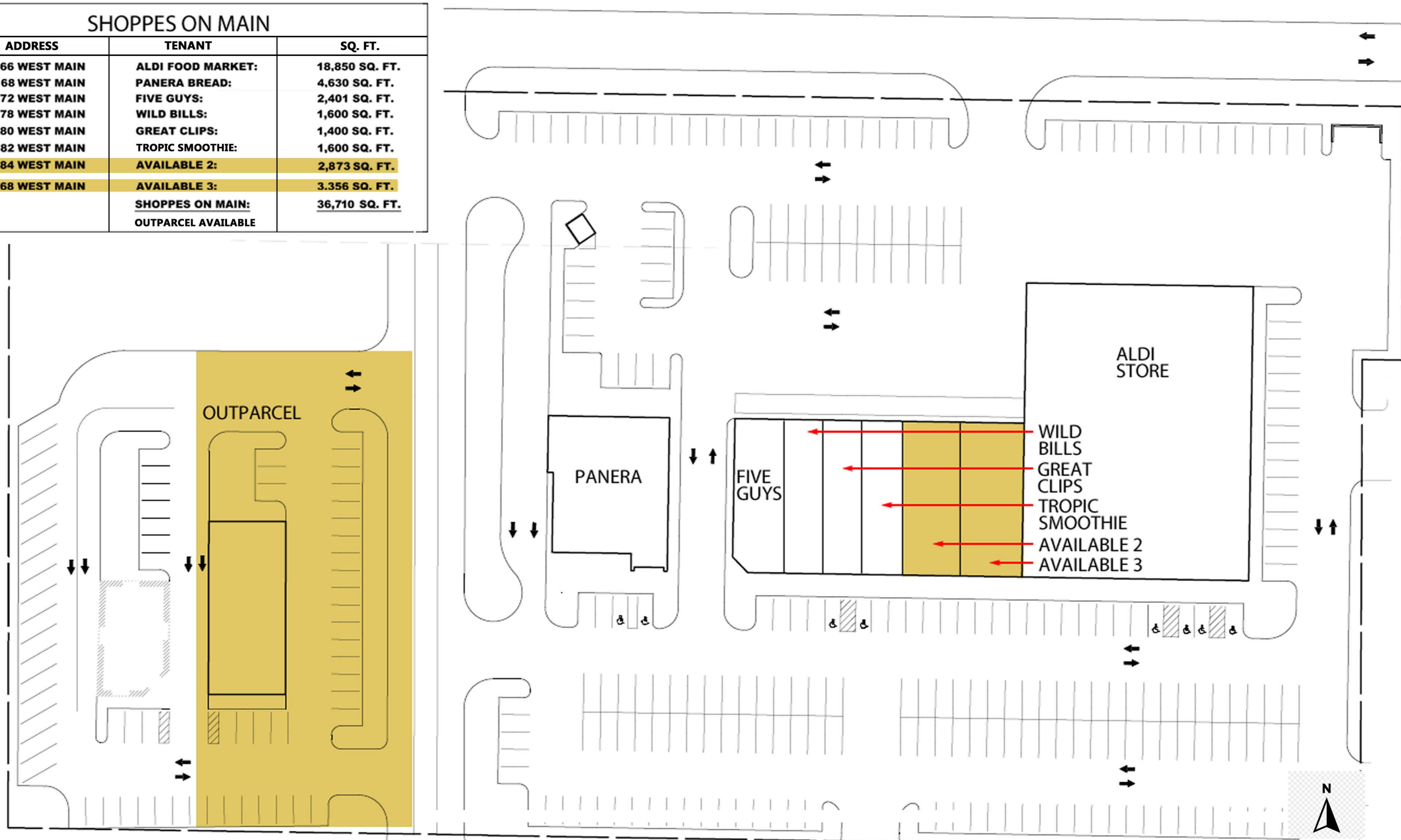

DEVELOPED BY:

TBO DEVELOPMENT COMPANY
 8673 CLAM LAKE ROAD
 BELLAIRE, MI 49615

LEASED AND MANAGED BY:

JOHN H. OVINGTON, PRESIDENT
 TBO DEVELOPMENT COMPANY
 PHONE: (248) 766-3400
 FAX: (989) 448-2029
 JOVINGTON@TBODEVELOPMENT.COM

